

XXXII INTERNATIONAL SCIENTIFIC CONFERENCE

EMPIRICAL STUDIES IN PSYCHOLOGY

MARCH 27–29, 2026

FACULTY OF PHILOSOPHY, UNIVERSITY OF BELGRADE



INSTITUTE OF PSYCHOLOGY
LABORATORY FOR EXPERIMENTAL PSYCHOLOGY
FACULTY OF PHILOSOPHY, UNIVERSITY OF BELGRADE

Scientific Committee

Programme Committee:

Zora Krnjaić (chairwoman), Laurie Beth Feldman, Agostini Tiziano, Maria do Céu Taveira, Sofia-Eleftheria Gonida, Zrinka Ristić Dedić, Žan Lep, Dragan Rangelov, Ivan Grahek, Slobodan Marković, Dušica Filipović Đurđević, Ljiljana Lazarević, Nataša Simić, Predrag Nedimović, Kaja Damnjanović, Marko Živanović, Marina Videnović, Milica Ninković, Milana Rajić, Teodora Vuletić Joksimović, Aleksandar Kostić, Nenad Havelka

Board of Reviewers:

Anja Wertag, Bojana Bodroža, Danka Purić, Darinka Anđelković, Dejan Todorović, Dobrinka Kuzmanović, Dragan Janković, Dragana Stanojević, Dragan Rangelov, Dražen Domijan, Goran Opačić, Ivan Grahek, Ivana Jakšić, Ivana Stepanović Ilić, Ivan Stojilović, Janko Međedović, Jelena Dostanić, Ksenija Krstić, Maja Savić, Marija Branković, Marija Čolić, Marija Petrović, Maša Vukčević Marković, Milica Vukelić, Nikola Petrović, Nebojša Majstorović, Oliver Tošković, Olja Jovanović, Pavle Valerjev, Petar Lukić, Predrag Teovanović, Smiljana Jošić, Sonja Janičić, Tamara Džamonja Ignjatović, Zrinka Ristić Dedić

Organizing committee:

Teodora Vuletić Joksimović (chairwoman), Zora Krnjaić, Ivana Stepanović Ilić, Ksenija Mišić, Kristina Mojović Zdravković, Milana Rajić, Sara Božić, Lenka Protić, Olga Marković Rosić, Vojin Simunović

Volunteers:

Aleksandra Filipović, Anđela Stefanović, Anastasija Milojević, Anđela Malinić, Đorđe Milovanović, Isidora Dobrijević, Katarina Mamula, Katarina Vulić, Kristina Bratić, Margo Šurlan, Marica Čelić, Marija Lazović, Marija Sekulić, Marta Ivanović, Marta Nikolić, Maša Katić, Milica Glišić, Milica Lalić, Mina Marković, Mina Todorović, Nataša Đukić, Nikola Anđelovski, Sara Denić, Simona Zrnić, Sofija Obradović, Sofija Vidmar, Tamara Todorović, Tijana Petrović, Una Pavićević, Velimir Stojković

Cover photo:
BONNARDEL
(Clamart, Seine)

An instrument for assessing oculomotor coordination and manual dexterity.

From the Collection of Old Scientific Instruments of the Laboratory of Experimental Psychology,
Faculty of Philosophy, University of Belgrade

OVERVIEW

	Friday, March 27th	Saturday, March 28th	Sunday, March 29th
08:30 – 09:00		Registration (2nd floor)	Registration (2nd floor)
09:00 – 09:15		Coffee	Coffee
09:15 – 09:30		Social psychology II (208)	Educational psychology II (208)
09:30 – 09:45		Clinical psychology I (105)	Psychology of Art (105)
09:45 – 10:00			
10:00 – 10:15		Coffee break (2nd floor)	Coffee break (2nd floor)
10:15 – 10:30		Organizational psychology (208)	Clinical psychology II (208)
10:30 – 10:45		Educational psychology I (105)	Cognitive psychology (105)
10:45 – 11:00			
11:00 – 11:15		Coffee break (2nd floor)	Coffee break (2nd floor)
11:15 – 11:30		Keynote lecture (Amf) EARLY DEVELOPMENT OF EXECUTIVE FUNCTIONS IN THE EVERYDAY LIFE <i>Cintia Rodriguez</i>	
11:30 – 11:45		Coffee break (2nd floor) + Promotion of "Psihološka istraživanja" Journal	Nenad Havelka award ceremony (Amf) Nenad Havelka lecture of honor (Amf) ON THE PSYCHOLOGY OF INTERACTIONS OF HUMANS WITH OTHER ANIMALS <i>Marija Branković</i>
11:45 – 12:00			
12:00 – 12:15		Poster session I (2nd floor)	Coffee break (2nd floor)
12:15 – 12:30			Poster session II (2nd floor)
12:30 – 12:45		Coffee break (2nd floor)	Coffee break (2nd floor)
12:45 – 13:00	Registration (2nd floor)		
13:00 – 13:15	Coffee break (2nd floor)	Psychology of Perception (208)	Workshop (108): SCIENCE COMMUNICATION 101: FROM RESEARCH TO REACH?
13:15 – 13:30	Social psychology I (108)	Personality psychology (108)	
13:30 – 13:45	Developmental psychology (208)		
13:45 – 14:00		Coffee break (2nd floor)	Coffee break (2nd floor)
14:00 – 14:15			Awards and closing ceremony (108)
14:15 – 14:30		Katarina Marić Foundation (101)	Round table (108): ETHICAL CHALLENGES IN EMPIRICAL RESEARCH IN PSYCHOLOGY
14:30 – 14:45			
14:45 – 15:00			
15:00 – 15:15			
15:15 – 15:30			
15:30 – 15:45			
15:45 – 16:00			
16:00 – 16:15			
16:15 – 16:30			
16:30 – 16:45			
16:45 – 17:00			
17:00 – 17:15			
17:15 – 17:30			
17:30 – 17:45			
17:45 – 18:00			
18:00 – 18:15			
18:15 – 18:30			
18:30 – 18:45			
18:45 – 19:00			
19:00 – 19:15			
19:15 – 19:30			
19:30 – 19:45			
19:45 – 20:00			
20:00			

OUR SPONSORS



Republic of Serbia

MINISTRY OF SCIENCE,
TECHNOLOGICAL DEVELOPMENT AND INNOVATION



LICEUJICE



FRIDAY, MARCH 27, 2026

13:30 – 14:30

hall | REGISTRATION

COFFEE BREAK @ HALL

14:30 – 16:00

**SOCIAL
PSYCHOLOGY I
108**

Chairs:
**Jovan Ivanović
Siniša Lakić**

BACKFIRE EFFECT OF A PERSPECTIVE-TAKING NARRATIVE INTERGROUP INTERVENTION

Una Branković, Tamara Milić, Ivana Milenković, Katarina Stošić, Ana Krtolica, Natalija Jovičević, Milica Ninković, Iris Žeželj

"BRAĆA JUGOSLOVENI": THE ROLE OF PERSONAL CONTACT AND NATIONALISM IN PREDICTING NEGATIVE STEREOTYPES ABOUT OTHER NATIONS

Žan Lep, Žiga Mekiš Recek

ETHNO-RELIGIOUS AND SUPRANATIONAL IDENTITY CONFIGURATIONS AMONG YOUTH IN THE REPUBLIC OF SRPSKA: A PERSON-CENTERED EXPLORATION

Siniša Lakić, Srđan Dušanić, Vladimir Turjačanin

ENGAGING CONFLICTING HISTORICAL NARRATIVES: EFFECTS OF MULTI-PERSPECTIVE INTERVENTION ON YOUTH INTERGROUP ATTITUDES AND HISTORICAL THINKING

Jovan Ivanović, Iris Žeželj, Aleksandar Baucal

COMPARISON OF THE EFFECTS OF DISCRIMINATION ON THE SOCIAL CONNECTEDNESS OF YOUNG ROMA AND MIGRANTS FROM SOCIETY

Sanja Batić Očovaj, Milisav Milinković

**DEVELOPMENTAL
PSYCHOLOGY
208**

Chairs:
**Kristina Mojović
Zdravković
Tanja Brcan**

EMOTIONAL REGULATION IN YOUNG MEN: THE ROLE OF MASCULINITY NORMS AND EMOTIONAL SOCIALIZATION

Jana Pavlović, Biljana Stanković

NAVIGATING EMOTIONAL EXPRESSION AND VULNERABILITY: EXPERIENCES OF YOUNG MEN IN ROMANTIC RELATIONSHIPS

Jana Pavlović, Biljana Stanković

SOCIAL AND MEDIA PRESSURE AND BODY IMAGE SATISFACTION IN ADOLESCENCE: THE MEDIATING ROLE OF SELF-ESTEEM

Tanja Brcan, Jasmina Pekić

PREDICTING LIFE SATISFACTION IN ADOLESCENTS: THE ROLE OF SOCIO-EMOTIONAL COMPETENCIES

Marija Trajković, Branislava Popović-Čitić, Lidija Bukvić, Dragana Bogičević, Marina Kovačević Lepojević

MEASURING EARLY SOCIAL COGNITION IN TÜRKİYE: A PSYCHOMETRIC STUDY

Burcu Soy Telli, Yesim Yavaslar Dogru, Gizem Koc-Arik, Elena Hoicka

COFFEE BREAK @ HALL



16:15 – 17:45

SYMPOSIUM 208	BASICS OF LIGHTNESS PERCEPTION: PHYSICS AND PHENOMENOLOGY Dejan Todorović, Anna Riga, Predrag Nedimović
Chair: Sunčica Zdravković	A REVIEW OF THE ANCHORING THEORY OF LIGHTNESS Elias Economou, Alan Gilchrist
	EMPIRICAL CHALLENGES TO THE ANCHORING THEORY Sunčica Zdravković, Elias Economou, Dejan Todorović
	NEW MODEL EXPLAINS ILLUMINATION-DEPENDENT ERRORS IN LIGHTNESS PERCEPTION Predrag Nedimović, Anna Riga, Elias Economou, Alan Gilchrist
	LIGHTNESS ERRORS AND PERCEPTUAL GROUPING Anna Riga, Predrag Nedimović, Dejan Todorović, Alan Gilchrist

COFFEE BREAK @ HALL

18:00 – 18:30

CONFERENCE OPENING amph	OPENING CEREMONY
--	-------------------------

18:30 – 20:00

KEYNOTE LECTURE amph	HOW WE APPROACH INTERPERSONAL CONFLICTS: STYLE OR SKILL? Tamara Džamonja Ignjatović
---	--

WELCOME COCKTAIL @ [KLUB PLATO](#)

SATURDAY, MARCH 28, 2026

8:30 – 9:00

hall | REGISTRATION

COFFEE BREAK @ HALL

9:00 – 10:30

**SOCIAL
PSYCHOLOGY II
208**

Chairs:
**Sara Dojčinović
Vojin Simunović**

DEMOGRAPHIC AND EMOTIONAL PREDICTORS OF STUDENT INVOLVEMENT IN UNIVERSITY BLOCKADES (2024/25)
Vojin Simunović, Biljana Jokić, Ljiljana B. Lazarević, Milica Manojlović, Matija Gvozden, Tamara Džamonja Ignjatović

LEXICAL SOCIAL ATTITUDES AND AMBIVALENT SEXISM IN SERBIA AND CROATIA
Sanda Stanković, Ljiljana B. Lazarević, Asmir Gračanin, Goran Knežević

VIRTUE TRUST: THE DEVELOPMENT OF THE SCALE
Milica Vdović, Selena Vračar, Enrico Rubaltelli

IN JOY AND SORROW – RELATIONSHIP DYNAMICS FROM THE PERSPECTIVE OF WOMEN GOING THROUGH IVF
Milica Skočajić

CIVIC ENGAGEMENT OF MENTAL HEALTH EXPERTS: A DELPHI CONSENSUS STUDY
Sara Dojčinović, Jana Dimoski, Marija Milovanović, Jasmina Bogdanović, Lena Matković, Milutin Kostić, Maša Vukčević Marković

**CLINICAL
PSYCHOLOGY
105**

Chairs:
**Neda Janićijević
Teodora Vuletić
Joksimović**

HOW FREQUENCY, DURATION, AND INTENSITY OF PHYSICAL ACTIVITY RELATE TO MENTAL HEALTH: A MULTIDOMAIN ANALYSIS
Nataša Savić, Danilo Abramović, Nikola Aćimović, Andrijana Arnaut, Arijana Radić, Lana Lugonja Prodanović, Siniša Subotić

SYMPTOM PERCEPTION AS A KEY PREDICTOR OF ASTHMA CONTROL: A FACTOR-ANALYTIC EXAMINATION OF THE BRIEF IPQ
Ana Komlenić, Sanja Hromiš, Anđela Keljanović

PREDICTIVE POWER OF THE FOMO EFFECT ON DEPRESSION, ANXIETY, STRESS, AND MENTAL HEALTH: THE MEDIATING ROLE OF EMOTION REGULATION STRATEGIES
Tijana Simić, Dragana Stanojević

THE MEDIATING ROLE OF PATHOLOGICAL PERSONALITY TRAITS AND EMOTIONAL REGULATION MOTIVES IN THE RELATION BETWEEN CHILDHOOD TRAUMA AND SUBSTANCE ABUSE
Marko Đurica

THE ASSOCIATION BETWEEN EMOTIONAL INTELLIGENCE AND VIDEO GAME ENGAGEMENT: A META-ANALYSIS
Neda Janićijević, Mateja Vrška, Aleksa Pavlović, Nikola Urošević, Srđan Bogojević, Danka Purić

COFFEE BREAK @ HALL

10:45 – 12:15

ORGANIZATIONAL PSYCHOLOGY 208	OCCUPATIONAL STRESS, HEALTH, AND THE SIGNIFICANCE OF ANTI-STRESS PROGRAMS IN THE MANUFACTURING AND SERVICE SECTORS Nebojša Majstorović, Ana Ivanov, Teodora Vujičić, Sara Mučibabić
Chairs: Ana Ivanov Nebojša Majstorović	WORK STRESS AS A MEDIATOR BETWEEN WORKPLACE CHARACTERISTICS AND JOB SATISFACTION AMONG CORRECTIONAL SECURITY OFFICERS Vicko Ćudina
	ROLE AMBIGUITY AND JOB SATISFACTION: THE ROLE OF POSITIVE RELATIONSHIP MANAGEMENT Ana Petrović, Ivana B. Petrović
	REDUCING EXPOSURE TO NEGATIVE ACTS AT WORK: INTERPLAY BETWEEN HUMAN CAPITAL SUSTAINABILITY LEADERSHIP AND PSYCHOSOCIAL CLIMATE Ivana Graovac, Milica Vukelić
	CYBERVETTING: COGNITIVE, EMOTIONAL AND BEHAVIORAL REACTIONS OBSERVED AMONG SERBIA'S YOUTH Maša Engler, Jelena Pavlović, Milanko Čabarkapa
EDUCATIONAL PSYCHOLOGY 105	EVALUATING THE COLLABORATIVE REPLICATION AND EDUCATION PROJECT AS A PEDAGOGICAL TOOL Jordan Wagge, Ljiljana Lazarević, Danka Purić
Chairs: Nataša Simić Marijana Vitorović	THE RELATIONSHIP BETWEEN SCHOOL CLIMATE AND MULTICULTURAL SCHOOL PRACTICES WITH THE SOCIAL IDENTIFICATION OF STUDENTS Marijana Vitorović, Danijela S. Petrović, Nataša Simić
	THE POTENTIAL OF DESIGN-BASED RESEARCH FOR INNOVATIVE TEACHING: TEACHERS' PERSPECTIVES ON STRENGTHS AND CHALLENGES Nataša Simić, Vladeta Milin, Jelena Vranješević
	DIFFERENCES IN INTERCULTURAL COMPETENCE AMONG TEACHERS ACROSS LEVELS OF SCHOOL CLIMATE PERCEPTION Milena Belić, Danijela S. Petrović, Đerđi Erdeš Kavečan
	ECEC TEACHERS' PEDAGOGICAL APPROACHES TO INTEGRATION OF EDUCATIONAL ROBOTS AS LEARNING TOOLS Ivana Vulic Šimšić, Milica Pupavac

COFFEE BREAK @ HALL

12:30 – 14:00

KEYNOTE LECTURE amph	EARLY DEVELOPMENT OF EXECUTIVE FUNCTIONS IN THE EVERYDAY LIFE Cintia Rodriguez
--------------------------------	--

COFFEE & SNACK BREAK @ HALL

PROMOTION OF "PSIHOLOŠKA ISTRAŽIVANJA" JOURNAL



15:00 – 16:30

Numbers next to posters indicate the number of the panel on which the poster should be displayed

**POSTER
SESSION I
hall**

- (1) THE ROLE OF OPTIMISM IN PREDICTING PHYSICAL HEALTH: EXPLORING THE MEDIATING EFFECTS OF HEALTH BEHAVIORS AND POSITIVE AFFECT
Katarina Protić
- (2) COGNITIVE STYLES AND STATISTICAL MINDWARE AS PREDICTORS OF PERFORMANCE AND CONFIDENCE IN REASONING PROBLEMS
Pavle Valerjev, Igor Bajšanski, Patrik Mandić
- (3) EPISTEMIC AUTHORITY TYPE AND RISKY DECISION-MAKING: ARE WE MORE RATIONAL WHEN ADVISED BY AI OR A SCIENTIST-PHYSICIAN?
Maša Andrić, Kaja Damnjanović
- (4) DELAY OF GRATIFICATION: REPLICATION OF AN ONLINE PROCEDURE AND ASSOCIATIONS WITH BMI AND QUALITY OF LIFE
Zorana Zupan, Lenka Protić, Kristina Dukić, Milica Mitić, Marina Videnović
- (5) “TRUE COLORS”: MUSIC GENRE PREFERENCES AND WELL-BEING IN SERBIAN ADOLESCENTS
Andela Milošević, Marko Vesić
- (6) THE THREE MUSKETEERS OF HIGHER-ORDER COGNITION RIDE AGAIN: IMPLICIT UNDERSTANDINGS OF INTELLIGENCE, CREATIVITY, AND WISDOM
Tamara Stanarević, Siniša Subotić
- (7) PREDICTING LEADERSHIP STYLE PREFERENCES FROM HEXACO PERSONALITY TRAITS
Danica Nikolić Vesković
- (8) BODY IMAGE, HEALTH-RELATED BEHAVIOURS, AND THE DARK TRAITS AS PREDICTORS OF OBJECTIFIED BODY CONSCIOUSNESS
Teodora Gligorić, Milica Klajn, Katarina Mašić Đonlić, Bojana Dinić
- (9) THE ROLE OF DARK PERSONALITY TRAITS IN PREDICTING HIGH SENSITIVITY
Isidora Rajić, Luna Radević, Anastasija Mitrović, Selka Sadiković
- (10) DARK TRIAD TRAITS AND THE PREVALENCE AND RELATIVE PROPORTION OF FRIENDS WITH BENEFITS RELATIONSHIPS AMONG EMERGING ADULTS
Katarina Živković, Andela Krivokapić, Ana Ivanov, Sanda Stanković
- (11) EXPLORING THE RELATIONSHIP BETWEEN PERSONALITY NUANCES AND OFFENCES USING NETWORK ANALYSIS
Anja Wertag, Ines Sučić, Bojana M. Dinić
- (12) WELL-BEING, RELIGIOSITY, AND SPIRITUALITY AS PREDICTORS OF LIFE SATISFACTION IN ADOLESCENTS
Milana Damjanić Mihaldžić, Lana Vujaković, Srđan Dušanić

- (13) FIFTY-FIFTY? OR NOT?: PATRIARCHAL VALUES AND HOUSEHOLD LABOR AS PREDICTORS OF WOMEN'S MENTAL HEALTH
Ivana Tisma, Aleksandra Prokić, Marija V. Čolić
- (14) WHAT SHAPES PHYSICAL APPEARANCE SATISFACTION? THE EFFECTS OF BODY SHAPE, BODY IMAGE, AND SELF-OBJECTIFICATION
Kristina Puzović, Bojana M. Dinić
- (15) THE EFFECT OF COLOR ON THE PERCEIVED OBJECTS' PRÄGNANZ
Aleksa Filipović, Oliver Tošković
- (16) DO REAL MEN EAT SAUERKRAUT: GENDERED PERCEPTIONS OF FOOD IN THE BALKANS
Anja Anđela Pantic, Ana Atanasković, Marija Branković
- (17) BIASES IN EMPATHIC RESPONSE BASED ON VICTIM GENDER
Violeta Mihajlovska, Kaja Damnjanović
- (18) LIFE SATISFACTION OF MEDIA WORKERS IN BOSNIA AND HERZEGOVINA
Srdjan Puhalo
- (19) CORRELATION ANALYSIS OF ATTITUDES TOWARD LGBT INDIVIDUALS AND TRADITIONAL VALUES
Srdjan Puhalo

COFFEE BREAK @ HALL

16:45 – 18:15

PERCEPTION 208	OUT OF THE DARK- PERCEIVED DISTANCE ANISOTROPY BETWEEN REDUCED AND FULL CUE SITUATION Oliver Tošković
Chairs: Nataša Mihajlović Oliver Tošković	INHIBITION IN VISUAL SEARCH TASK DOES NOT REQUIRE PRECISELY DEFINED DISTRACTOR TEMPLATE Nataša Mihajlović, Sunčica Zdravković
	A NEURAL MODEL OF TOP-DOWN FEATURE GUIDANCE OF SPATIAL ATTENTION Dražen Domijan, Nataša Mihajlović
	USING EYE MOVEMENTS TO NAVIGATE REMOTE MOBILE SYSTEMS Sunčica Zdravković, Sanja Mandić, Đorđe Novaković, Nemanja Gazivoda, Bojan Vujičić, Dragan Pejić, Platon Sovilj
	ROBUSTNESS OF BASIC EMOTION RECOGNITION UNDER VISUAL DEGRADATION AND LIMITED EXPOSURE TIME Stanislava Kozakijević, Milica Popović Stijačić

PERSONALITY PSYCHOLOGY 108	<p>THE MODERATING ROLE OF SEX IN THE RELATIONSHIP BETWEEN DARK TETRAD TRAITS AND PSYCHOPATHOLOGY Matija Gvozden, Jana Dimoski, Janko Mededović</p>
<p>Chairs: Matija Gvozden Janko Mededović</p>	<p>PSYCHOSIS-PRONENESS AND FERTILITY: THE MEDIATING ROLE OF REPRODUCTIVE MOTIVATION Dunja Vujošević, Isidora Đorđević, Janko Mededović</p>
	<p>ROLE OF HIGH SENSITIVITY IN PREDICTING PEER VIOLENCE AND VICTIMIZATION IN ADOLESCENTS Elena Vitomir, Bojana M. Dinić, Isidora Rajić</p>
	<p>“WITH A LITTLE HELP OF MY FRIENDS”: PREDICTING ANTISOCIAL OUTCOMES WITH SELF AND FRIENDS’ DARK TRAITS Đorđe Volarević, Svetlana Pavlović, Nikola Drndarević, Marija Čolić, Janko Mededović</p>
	<p>COMPUTER MOUSE AS A PROXY FOR GAZE? SACCADE IDENTIFICATION AND STRATEGY ASSESSMENT IN AN UNINSTRUMENTED VISUAL SEARCH Anastasija Mladić, Smilja Stokanović, Jaka Sodnik, Nadica Miljković</p>
	<p>WE’RE ALL JUST TWO BAD SCORES AWAY FROM WRECKAGE: HOW PERSONALITY TRAITS PREDICT DRIVING BEHAVIOURS Arijana Radić, Aleksandar Tošić, Anastasija Jerinić, David Čajić, Svetlana Borojević</p>

COFFEE BREAK @ HALL

18:30 – 20:00

KATARINA MARIĆ FOUNDATION 101	<p>BEST MASTER THESIS IN PSYCHOLOGY AWARD CEREMONY AND FINALISTS PRESENTATIONS</p>
<p>Chair: Nevena Buđevac</p>	

SUNDAY, MARCH 29, 2026

8:30 – 9:00

hall | REGISTRATION

COFFEE BREAK @ HALL

9:00 – 10:30

**DEVELOPMENTAL
& EDUCATIONAL
PSYCHOLOGY
208**

Chairs:
**Katarina Mičić
Nikola Adamov**

TIME ONLINE AND INTERNET ADDICTION AMONG YOUTH: THE MEDIATING ROLE OF MOTIVATED STRATEGIES FOR LEARNING
Nikola Adamov, Ilija Milovanović

KEEPING THE MATH SPARK ALIVE: HOW TEACHER PRACTICES SHAPE TRAJECTORIES OF STUDENTS' INTRINSIC MOTIVATION
Katarina Mičić, Barbara Blažanin, Ksenija Krstić, Aleksandar Baucał

HOW STUDENTS WORK TOGETHER: CLUSTER-BASED INSIGHTS INTO EFFECTIVE AND INEFFECTIVE COLLABORATIVE PROBLEM SOLVING
Marina Videnović, Smiljana Jošić, Ivana Stepanović Ilić

MUSICAL ACTIVITIES AND SOCIO-EMOTIONAL AND BEHAVIORAL SKILLS OF ROMA CHILDREN
Blanka Bogunović, Tara Veljković, Maša Brkanović, Emilija Maksimović

“YOU DID [X], NOW I’LL SPANK YOUR ASS”: PARENTAL REASONS FOR ENDORSING CORPORAL PUNISHMENT OF CHILDREN
Jelena Bačić, Lana Aničić, Milica Ćurčija, Andela Popović, Andrijana Arnaut, Arijana Radić, Siniša Subotić

**PSYCHOLOGY OF
ART
105**

Chairs:
**Milica Popović
Stijačić
Ivan Stojilović**

MEASURING THE EXPERIENCE OF FRESCO ART: DEVELOPMENT AND VALIDATION OF A SIX-DIMENSIONAL SCALE
Ivan Stojilović, Tijana Todić Jakšić, Aleksandra Dimitrijević, Isidora Komadina, Jugoslava Rakić

THE EFFECT OF NARRATIVE ON THE AESTHETIC EVALUATION OF YUGOSLAV INDUSTRIAL DESIGN: ROLE OF VICARIOUS NOSTALGIA
Jelena Stanojević, Lara Perić

WHO CREATED THAT PIECE? AI- AND GENDER-BIAS IN CREATIVITY JUDGMENTS REGARDING PAINTINGS AND POEMS
Mina Hagen, Johannes Keller, Milica Popović Stijačić

SOUNDTRACK OF RESISTANCE: MUSIC LISTENING PRACTICES AND THEIR MOTIVATIONAL ROLE DURING STUDENT BLOCKADES IN SERBIA
Andela Milošević, Marko Vesić

‘HEART DRUMS THE ETERNAL TAM-TAM OF RESISTANCE’: MUSICAL ACTIVITIES DURING THE STUDENT BLOCKADES IN SERBIA
Marko Vesić, Andela Milošević

COFFEE BREAK @ HALL

10:45 – 12:15

**CLINICAL
PSYCHOLOGY II
208**

Chairs:
**Draga Šapić
Ivana Peruničić
Mladenović**

**DARK TRAITS GO ONLINE: MOTIVATIONAL PATHWAYS TO SOCIAL MEDIA SCREEN TIME
Jelena Spasić, Ivana Peruničić-Mladenović, Nikola Petrović, Dragan Bjelica**

**IMPROVING PSYCHOTHERAPY TRAINEES' WELL-BEING USING FUTURE-ORIENTED INTERVENTIONS
Olga Tuchina, Dmitri Shustov**

**BEHIND WORK-RELATED STRESS: A PILOT QUALITATIVE STUDY OF COMMON THEMES IN PSYCHOLOGICAL SUPPORT SESSIONS
Draga Šapić, Marijana Vitorović**

**MENTAL HEALTH OF REFUGEES IN TRANSIT: SEVEN-YEAR DATA TRENDS
Jana Dimoski, Draga Šapić, Isidora Živić, Irena Stanković, Aleksandra Bobić
Irena Stojadinović Vujičić, Maša Vukčević Marković**

**BUILDING THE BLUEPRINT: A QUALITATIVE SYNTHESIS OF COMMUNITY-BASED MENTAL HEALTH STANDARDS
Irena Stojadinović Vujičić, Teodra Mašković Đeri, Biljana Stanković, Maša Vukčević Marković**

**COGNITIVE
PSYCHOLOGY
105**

Chairs:
**Filip Nenadić
Sara Božić**

**WHEN HEURISTICS DUNK ON BAYES: A NOVEL PARADIGM REVEALS POSTERIOR PROBABILITY NOT UTILIZED IN THE BASE RATE TASK
Pavle Valerjev, Marin Dujmović**

**ANSWER CHANGING IN INTELLIGENCE TESTS – METACOGNITIVE CONTROL AND THE INTERPLAY BETWEEN INTELLIGENCE, PERSONALITY AND RETROSPECTIVE CONFIDENCE
Milica Manojlović, Goran Opačić**

**SIMULATING PHRASE FREQUENCY EFFECTS FROM A PICTURE NAMING TASK USING DISCRIMINATIVE LEARNING
Filip Nenadić, Ksenija Mišić, Audrey Bürki Foschini, Petar Milin**

**THE EFFECT OF BOOSTING SENSORY INFORMATION ON THE PRIMING EFFECT BETWEEN TWO POLYSEMOUS SENSES
Sara Božić, Dušica Filipović Đurđević**

**STABILITY OF THE EMOTIONAL EXPERIENCE OF WORDS: THE INFLUENCE OF INDUCED COGNITIVE CONTROL AND LOCAL CONTEXT
Aleksandra Stanimirović, Dušica Filipović Đurđević**

COFFEE BREAK @ HALL

12:30 – 14:00

**NENAD HAVELKA
LECTURE OF
HONOR
amph**

**AWARD CEREMONY
ON THE PSYCHOLOGY OF INTERACTIONS OF HUMANS WITH OTHER ANIMALS
Marija Branković**

COFFEE & SNACK BREAK @ HALL

15:00 – 16:30

Numbers next to posters indicate the number of the panel on which the poster should be displayed

**POSTER
SESSION II
hall**

- (20)** DEPRESSION/ANXIETY AND PROBLEMATIC SMARTPHONE USE: MEDIATING ROLES OF MINDFULNESS, DISTRESS TOLERANCE AND EXPERIENTIAL AVOIDANCE
Adrijana Harangozo, Sanda Stanković, Tatjana Vukosavljević Gvozden

- (21)** ARE WE AS MORAL AS WE CLAIM? TESTING THE HYBRID MODEL OF DUAL INTUITIONS IN THE CONTEXT OF TWO-DIMENSIONAL UTILITARIANISM
Andela Milojević, Iva Lazić

- (22)** MODELING THE SENSE UNCERTAINTY EFFECT IN POLYSEMY USING LDL: EVALUATING CONTEXTUAL CUES AND OUTCOMES
Ksenija Mišić, Dušica Filipović Đurđević

- (23)** RECOGNIZING EMOTIONAL FACIAL EXPRESSIONS: THE ROLE OF ACADEMIC PROGRAMME AND THE INFORMATIONAL VALUE OF FACIAL REGIONS
Dragana Vučenović, Svetlana Borojević

- (24)** JOB SATISFACTION AND TEACHERS' PERSONALITY TRAITS: A TYPOLOGICAL PERSPECTIVE
Jelena Prijjić, Ilija Milovanović

- (25)** ANALYZING SENTIMENT TOWARD MATHEMATICS IN SERBIAN: EVIDENCE FROM THE SRWAC AND REDDIT DATA
Isidora Gatarić

- (26)** APPLICATION OF MACHINE LEARNING METHODS TO THE CLUSTERING OF BFI-2 PERSONALITY PROFILES
Isidora Gatarić

- (27)** DO HELPING PROFESSIONALS RECOGNIZE EMOTIONS MORE ACCURATELY? EXAMINING THE ROLE OF EXPERIENCE
Kristina Kalaba Tošić, Svetlana Borojević

- (28)** ACADEMIC STAGE AND ACADEMIC PROCRASTINATION: THE ROLE OF MAXIMIZING–SATISFICING TENDENCIES
Pavle Mačkić

- (29)** THE ASSOCIATIONS BETWEEN BASIC PERSONALITY DIMENSIONS, COPING STYLES, AND LEVELS OF DEPRESSION, ANXIETY, AND STRESS AMONG STUDENTS
Kristina Milutinović, Miljana Pavićević

- (30)** THE RELATIONSHIP BETWEEN GRANDIOSE AND VULNERABLE NARCISSISM AND HEXACO PERSONALITY DIMENSIONS IN HIGH SCHOOL ADOLESCENTS
Nenad Lazarević

- (31)** RELATION BETWEEN THE DARK TRIAD TRAITS AND HEXACO PERSONALITY DIMENSIONS IN HIGH SCHOOL ADOLESCENTS
Nenad Lazarević

- (32) FACTORIAL VALIDITY OF THE THREE-DIMENSIONAL POLITICAL ORIENTATION QUESTIONNAIRE IN THE SERBIAN CONTEXT
Katarina Stošić, Una Branković, Tamara Milić, Ivana Milenković & Milica Ninković
- (33) PARENTS' AND TEACHERS' MEDIATION OF ADOLESCENT GENERATIVE ARTIFICIAL INTELLIGENCE (GENAI) USE IN SERBIA
Tijana Milošević, Dobrinka Kuzmanović
- (34) FREE SPEECH-TO-TEXT SOFTWARE FOR SERBIAN: A STEP-BY-STEP TUTORIAL AND EVALUATION USING NOISY INTERVIEW RECORDINGS
Nevena Mijatović
- (35) THE RELATIONSHIP BETWEEN MONEY MANAGEMENT STYLES AND THE SUBJECTIVE PERCEPTION OF RELATIONSHIP SATISFACTION AMONG COHABITING PARTNERS IN SERBIA
Magdalena Pistolčić
- (36) DO AUTHORITARIANISM AND TRUST IN SCIENCE PREDICT CONSPIRACY MENTALITY AND IN WHAT WAY
Jana Božović, Iva Vučetić
- (37) WHOM TO TRUST: ANOMIE, RWA, AND THE CONSPIRACY MENTALITY
Dunja Mićunović, Anja Bošnjak

COFFEE BREAK @ HALL

16:45 – 18:15

WORKSHOP | SCIENCE COMMUNICATION 101: FROM RESEARCH TO REACH?
108 | **Katarina Stekić Stojanović**

COFFEE BREAK @ HALL

18:30 – 19:00

CONFERENCE | AWARDS AND CLOSING CEREMONY
CLOSING
108

19:00 – 20:00

ROUND | ETHICAL CHALLENGES IN EMPIRICAL RESEARCH IN PSYCHOLOGY
TABLE | **Ana Radanović, Danka Purić, Dobrinka Kuzmanović, Ivana Petrović,**
108 | **Teodora Vuletić Joksimović**

Chair:
Ksenija Krstić

FLOOR PLAN

MEZZANINE

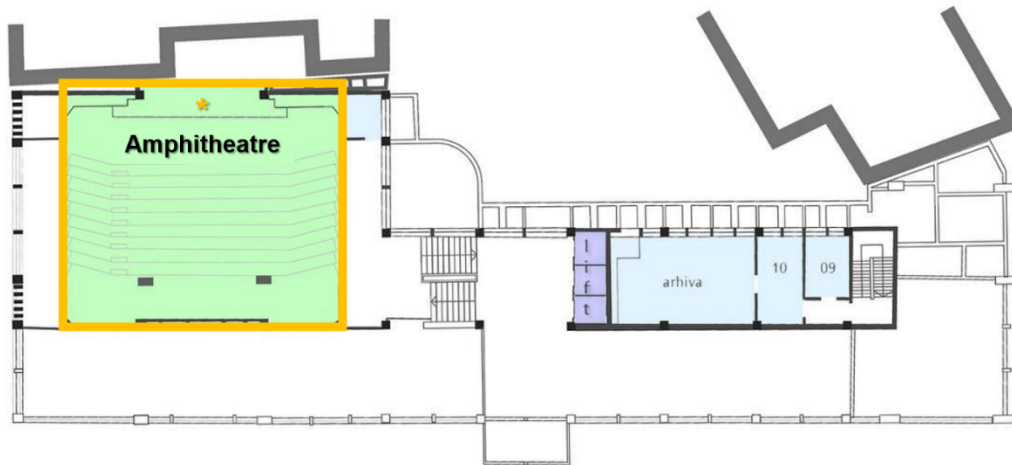

FLOOR



